

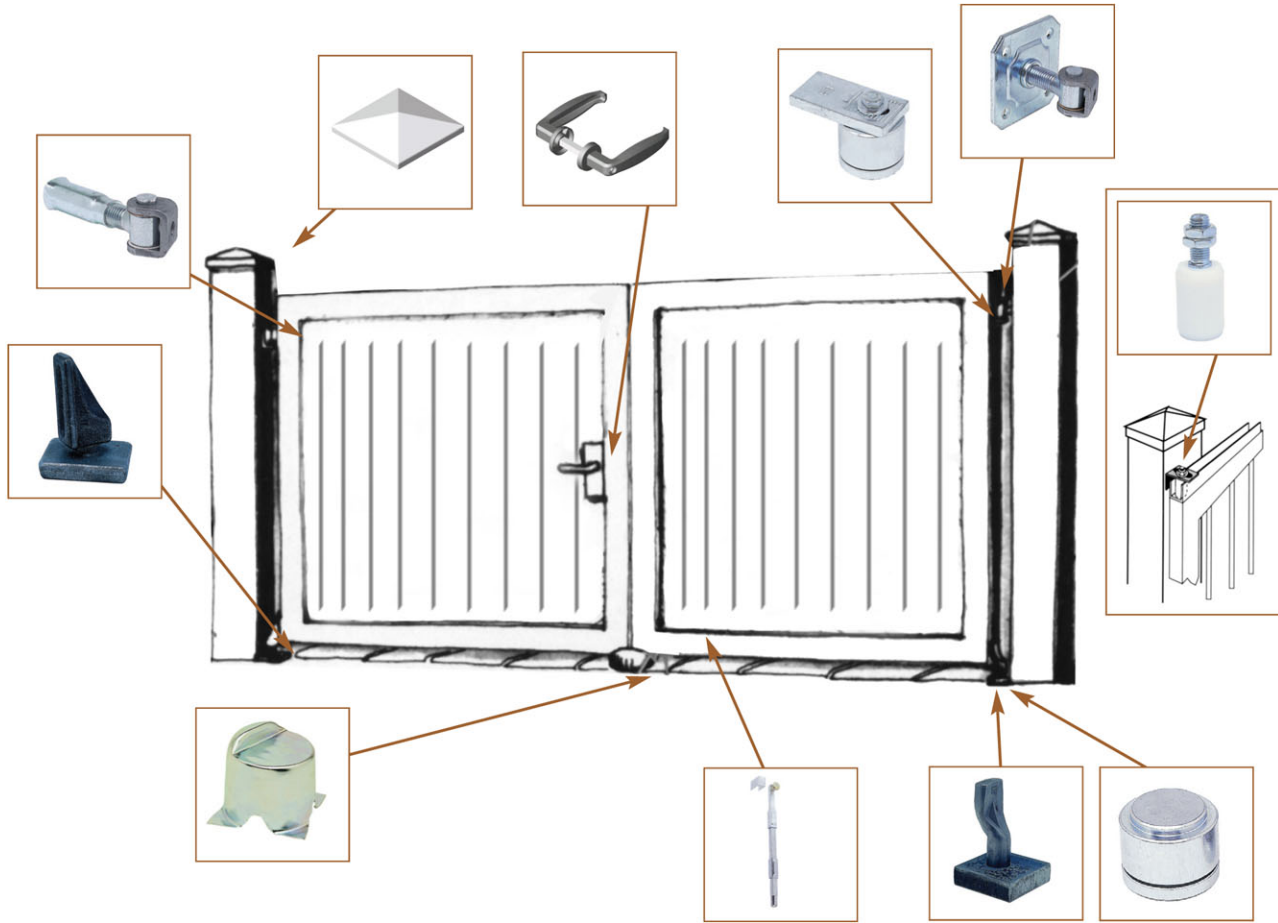

Code	Page	Code	Page	Code	Page	Code	Page	Code	Page	Code	Page
4350601	2	4321201	4	4470030	7	4464050	12	4490040	17		
4350803	2	4321202	4	4470040	7	4465040	12	4490050	17		
4350600	2	4321601	4	4470050	7	4465050	12	4490060	17		
4360801	2	4321302	4	4470060	7	4465098	13	4490080	17		
4361001	2	4322001	4	4420025	8	4466012	13	4490100	17		
4361011	2	4322002	4	4420030	8	4910140	13	4490120	17		
4361201	2	4370017	5	4420040	8	4910160	13	4490150	17		
4361211	2	4370015	5	4500030	8	4460000	13	4480076	17		
4361401	2	4370002	5	4500040	8	4470024	13	4480101	17		
4360800	3	4370003	5	4421042	8	4480024	13	4380059	19		
4361000	3	4370012	5	4410035	8	4460020	14	4380088	19		
4361010	3	4370013	5	4400001	8	4460024	14	4380126	19		
4361200	3	4370014	5	4400000	8	4460120	14	4440078	19		
4361210	3	4370009	5	4450002	9	4460124	14	4440113	19		
4361400	3	4370020	5	4450000	9	4462020	14	4440154	19		
4341001	3	4370019	5	4450040	9	4462124	14	4440067	19		
4341201	3	4370001	5	4450050	9	4465020	14	4440100	19		
4341000	3	4370000	5	4450020	9	4465046	14	4440140	19		
4341200	3	4370018	5	4450030	9	4463020	14	4373061	19		
4330601	4	4465007	6	4452090	9	4460065	15	4373090	19		
4330801	4	4465027	6	4451020	9	4461035	15	4373128	19		
4331001	4	4321071	6	4451120	9	4467035	15	4510016	19		
4331002	4	4321271	6	4451121	9	4467040	15	4510020	19		
4331201	4	4331071	6	4430000	10	4463022	15	4540000	20		
4331202	4	4331271	6	4430010	10	4461135	15	4541012	20		
4331601	4	4361071	6	4430020	10	4461140	15	4541016	20		
4331602	4	4361271	6	4440000	11	4530016	16	4542012	20		
4332001	4	4361070	6	4440001	11	4530000	16	4542016	20		
4332002	4	4361270	6	4464000	12	4530005	16	4551114	20		
4320601	4	4420037	7	4465000	12	4520033	16	4551116	20		
4320801	4	4420047	7	4465068	12	4521020	16	4552114	20		
4321001	4	4464057	7	4464035	12	4480076	17	4552116	20		
4321002	4	4465340	7	4464040	12	4480101	17	4553116	20		

EXEMPLES DE MONTAGES

PORTAIL BATTANT



PORTAIL COULISSANT

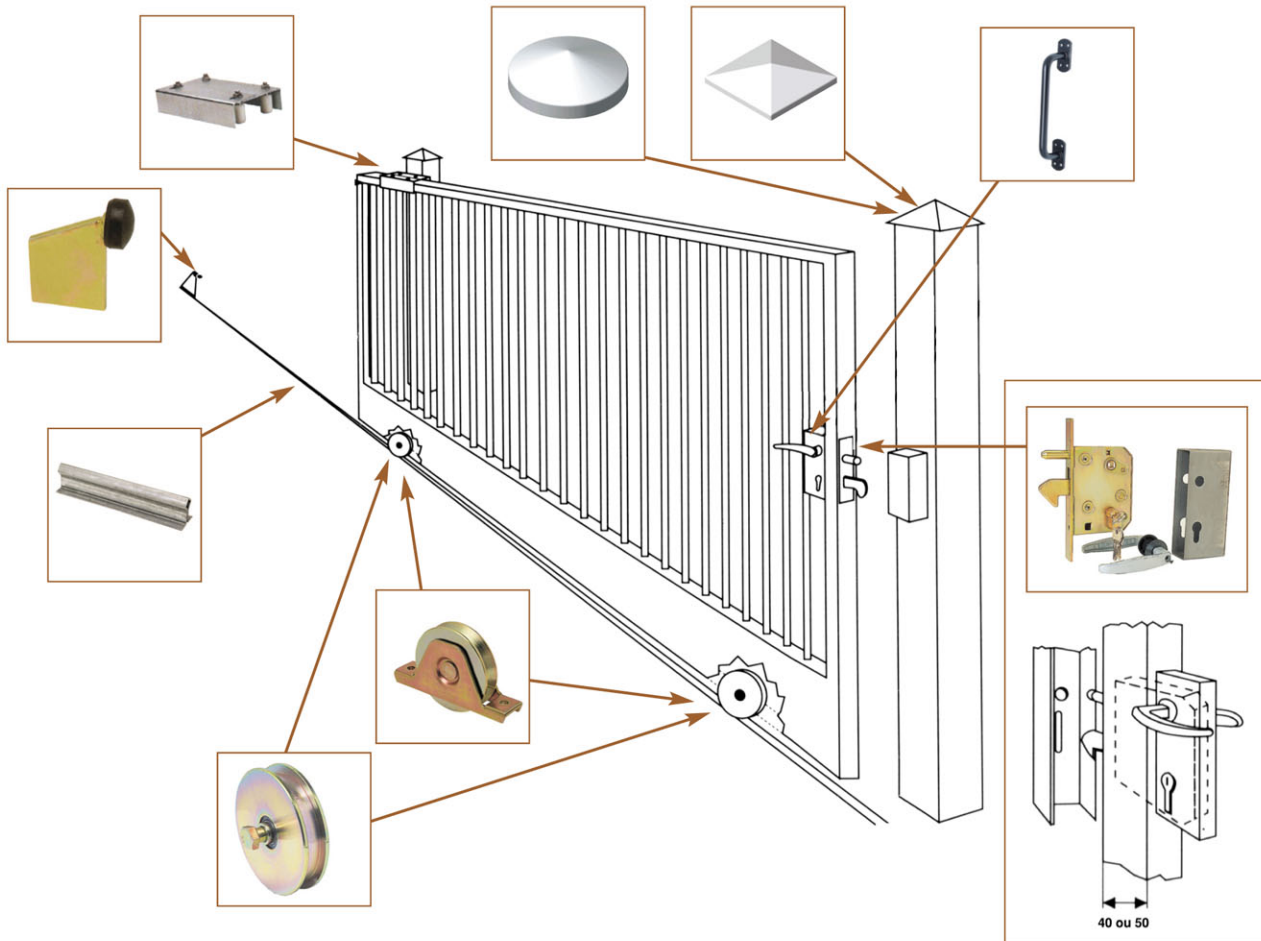

SYMBOLES



Diamètre en mm



Dimension du tube carré



Capacité de charge en daN (ou kg)



Poids en daN (ou kg)



Nombre de roulements à billes de précision

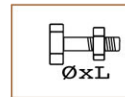

Boulon de fixation en mm



Conditionnement



EAN 13 GENCOD

ROUES AVEC SUPPORT

SUPPORT EXTERIEUR GORGE RONDE

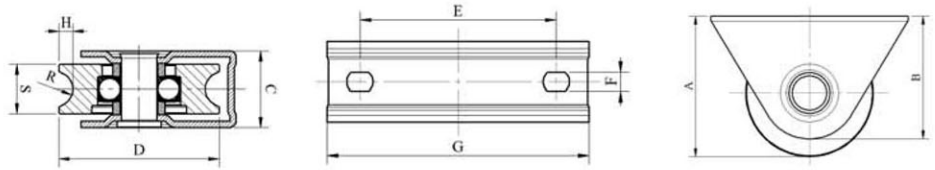
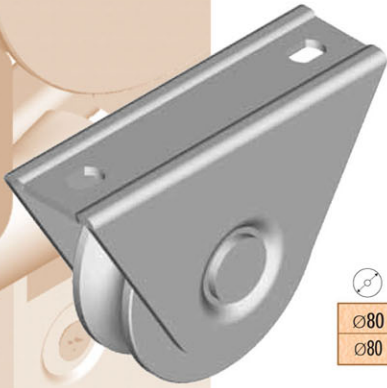

	Rail	A	B	C	D	E	F	G	H	S	R				CODE		EAN 13	
	ø80	ø16	86	75	37	ø77,5	90	8,5x12	120	6,8	24	8,3	1	200 kg	0,895 kg	435 0601	6	339680740039 4
	ø80	ø20	86	75	37	ø77,5	90	8,5x12	120	9,3	24	10,3	1	200 kg	0,893 kg	435 0803	6	339680740130 8

SUPPORT EXTERIEUR GORGE TRIANGULAIRE

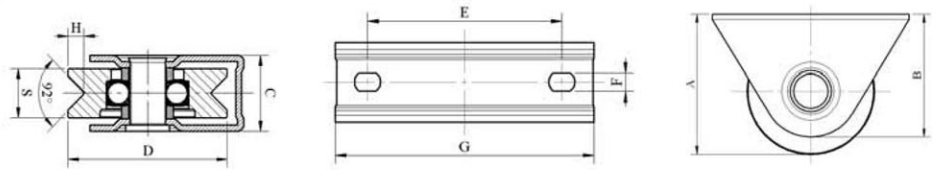

	Rail	A	B	C	D	E	F	G	H	S	R				CODE		EAN 13
	ø80	Triangulaire	86	75	37	ø77,5	90	8,5x12	120	7,8	24	1	200 kg	0,908 kg	435 0600	6	339680740038 7

SUPPORT INTERIEUR GORGE RONDE

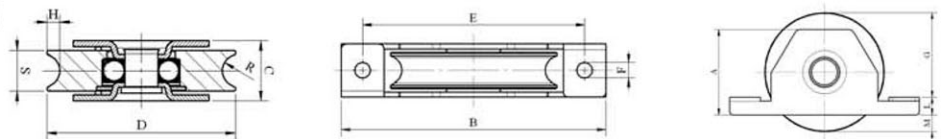
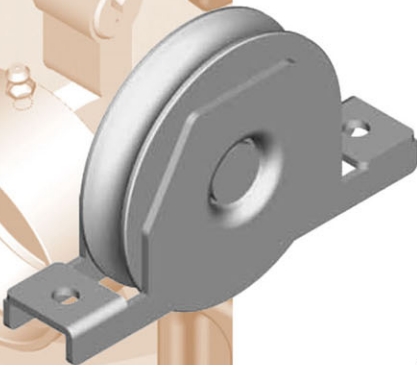

	Rail	A	B	C	D	E	F	G	H	L	M	S	R				CODE		EAN 13	
	ø80	ø16	52	135	32	ø77,5	110	ø9	49,5	6,8	14	14	20	8,3	1	200 kg	0,760 kg	436 0801	4	339680740042 4
	ø100	ø16	70	155	32	ø97,5	130	ø9	69	6,8	14,5	14	21	8,3	1	230 kg	1,140 kg	436 1001	6	339680740044 8
	ø100	ø20	70	155	32	ø97,5	130	ø9	69	10,3	14,5	14	28	10,3	2	350 kg	1,550 kg	436 1011	6	339680740131 5
	ø120	ø20	80	185	34	ø117,5	155	ø9	85,5	9,3	15	17	24	10,3	1	250 kg	2,250 kg	436 1201	6	339680740046 2
	ø120	ø20	80	185	44	ø117,5	155	ø9	85,5	10,3	15	17	28	10,3	2	500 kg	2,474 kg	436 1211	4	339680740132 2
	ø140	ø20	94	205	34	ø135,5	175	ø11	105	10,3	17	15,5	25	10,3	1	280 kg	3,100 kg	436 1401	6	339680740048 6

ROUES AVEC SUPPORT

SUPPORT INTERIEUR GORGE TRIANGULAIRE

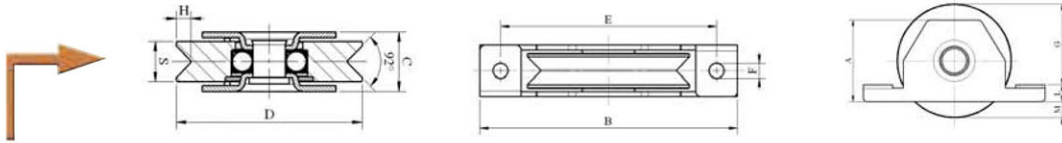

	Rail	A	B	C	D	E	F	G	H	L	M	S				CODE		EAN 13
∅80	Triangulaire	52	135	32	∅77,5	110	∅9	49,5	7,8	14	14	20	1	200 kg	0,787 kg	436 0800	4	339680740041 7
∅100	Triangulaire	70	155	32	∅97,5	130	∅9	69	7,8	14,5	14	21	1	230 kg	1,190 kg	436 1000	6	339680740043 1
∅100	Triangulaire	70	155	44	∅97,5	130	∅9	69	10,3	14,5	14	28	2	350 kg	1,673 kg	436 1010	6	339680740133 9
∅120	Triangulaire	80	185	34	∅117,5	155	∅9	85,5	8,8	15	17	24	1	250 kg	1,941 kg	436 1200	6	339680740045 5
∅120	Triangulaire	80	185	44	∅117,5	155	∅9	85,5	10,3	15	17	28	2	500 kg	2,602 kg	436 1210	4	339680740134 6
∅140	Triangulaire	94	205	34	∅135,5	175	∅11	105	9,8	17	15,5	25	1	300 kg	2,825 kg	436 1400	6	339680740047 9

SUPPORT A PLAQUE LATERALE GEORGE RONDE

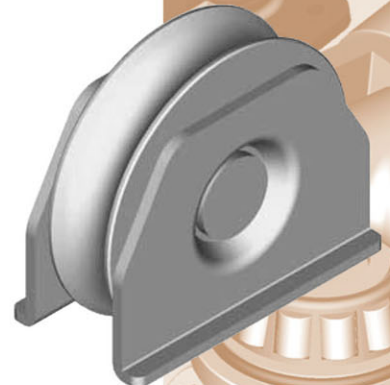
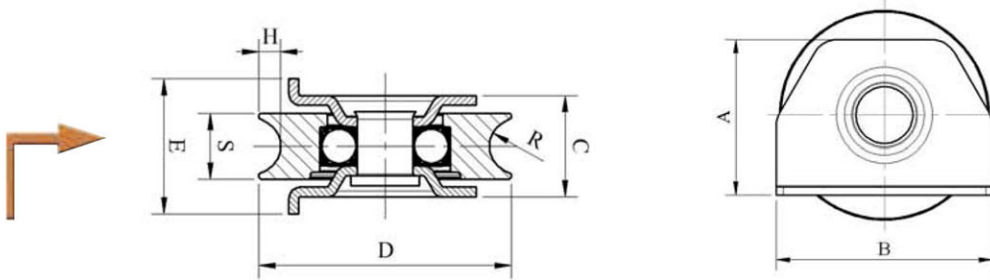

	Rail	A	B	C	D	E	H	S	R				CODE		EAN 13
∅100	∅16	67	100	31	∅97,5	43	6,8	21	8,3	1	230 kg	1,134 kg	434 1001	6	339680740033 2
∅120	∅20	79	120	34	∅117,5	46	9,3	24	10,3	1	250 kg	1,760 kg	434 1201	6	339680740135 3

SUPPORT A PLAQUE LATERALE GORGE TRIANGULAIRE

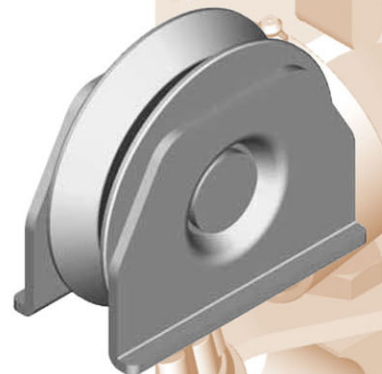
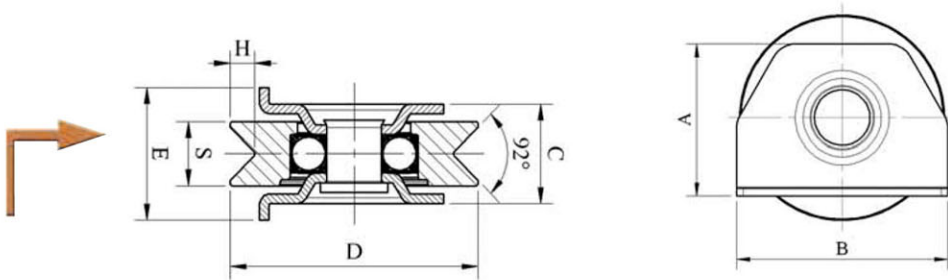

	Rail	A	B	C	D	E	H	S				CODE		EAN 13
∅100	Triangulaire	67	100	31	∅97,5	43	7,8	21	1	230 kg	1,182 kg	434 1000	6	339680740032 5
∅120	Triangulaire	79	120	34	∅117,5	46	8,8	24	1	250 kg	1,916 kg	434 1200	6	339680740034 9

ROUES A GORGE

ROUE A GORGE RONDE

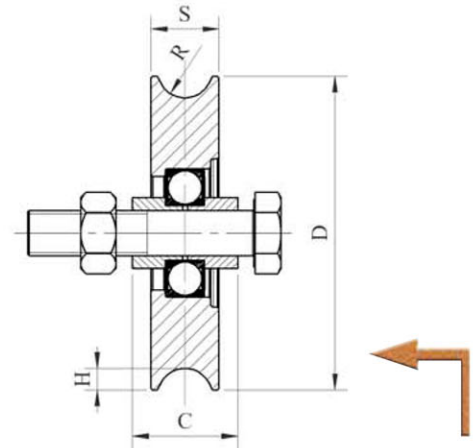
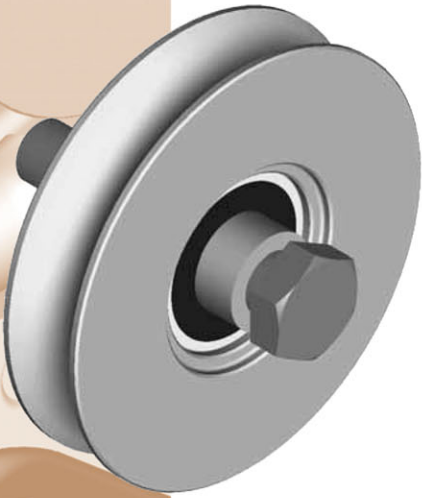

Ø	Rail	C	D	H	S	R	dxL	dxL	kg	kg	CODE	dxL	EAN 13
Ø60	Ø10	24	Ø58	5	17	5,3	1	M10x45	100 kg	0,302 kg	433 0601	12	339680740020 2
Ø80	Ø16	34	Ø77,5	6,8	20	8,3	1	M14x70	300 kg	0,647 kg	433 0801	6	339680740021 9
Ø100	Ø16	34	Ø97,5	6,8	21	8,3	1	M14x70	280 kg	1,005 kg	433 1001	6	339680740022 6
Ø100	Ø20	44	Ø97,5	10,3	28	10,3	2	M14x70	750 kg	1,416 kg	433 1002	6	339680740023 3
Ø120	Ø20	34	Ø117,5	9,3	24	10,3	1	M14x70	410 kg	1,544 kg	433 1201	4	339680740024 0
Ø120	Ø20	44	Ø117,5	10,3	28	10,3	2	M14x70	800 kg	2,103 kg	433 1202	6	339680740025 7
Ø160	Ø20	44	Ø157,5	10,3	25	10,3	1	M16x70	550 kg	3,580 kg	433 1601	2	339680740028 8
Ø160	Ø20	44	Ø157,5	10,3	32	10,3	2	M16x70	1000 kg	4,456 kg	433 1602	2	339680740029 5
Ø200	Ø20	44	Ø197,5	10,3	25	10,3	1	M16x70	600 kg	5,780 kg	433 2001	2	339680740030 1
Ø200	Ø20	44	Ø197,5	10,3	32	10,3	2	M16x70	1200 kg	7,065 kg	433 2002	2	339680740031 8

ROUE A GORGE TRIANGULAIRE

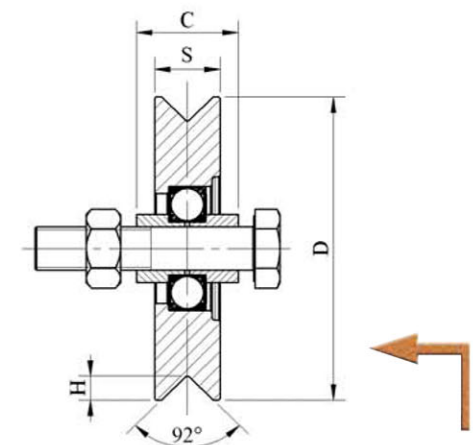

Ø	Rail	C	D	H	S	R	dxL	dxL	kg	kg	CODE	dxL	EAN 13
Ø60	Triangulaire	24	Ø58	6	17	1	M10x45	250 kg	0,294 kg	432 0601	12	339680740138 4	
Ø80	Triangulaire	34	Ø77,5	7,8	20	1	M14x70	300 kg	0,635 kg	432 0801	6	339680740009 7	
Ø100	Triangulaire	34	Ø97,5	7,8	21	1	M14x70	380 kg	1,047 kg	432 1001	6	339680740010 3	
Ø100	Triangulaire	44	Ø97,5	10,3	28	2	M14x70	750 kg	1,416 kg	432 1002	6	339680740011 0	
Ø120	Triangulaire	34	Ø117,5	8,8	24	1	M14x70	410 kg	1,561 kg	432 1201	4	339680740012 7	
Ø120	Triangulaire	44	Ø117,5	10,3	28	2	M14x70	800 kg	2,103 kg	432 1202	6	339680740013 4	
Ø160	Triangulaire	44	Ø157,5	9,8	25	1	M14x70	550 kg	3,470 kg	432 1601	2	339680740016 5	
Ø160	Triangulaire	44	Ø157,5	10,3	32	2	M16x70	1000 kg	4,465 kg	432 1302	2	339680740139 1	
Ø200	Triangulaire	44	Ø197,5	9,8	25	1	M16x70	600 kg	5,537 kg	432 2001	2	339680740018 9	
Ø200	Triangulaire	44	Ø197,5	10,3	32	2	M16x70	1200 kg	7,065 kg	432 2002	2	339680740019 6	

RAILS - CREMAILLERES

RAIL ROND A SCELLER

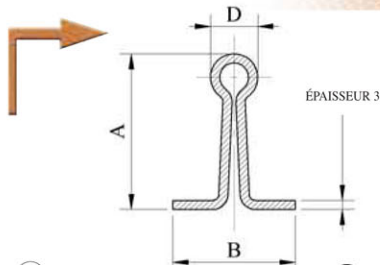

Pièce de Jonction

Ø	CODE	Nbr	EA	EA N 13
Ø16	437 0017	1	339680740124	7
Ø20	437 0015	1	339680740125	4

Ø	A	B	D	Longueur	Poids	Poids	CODE	Nbr	EA N 13
Ø16	51	40	Ø15,5	3 m	500 kg	8,6 kg	437 0002	3	339680740116 2
Ø20	63	50	Ø19,5	3 m	1000 kg	11 kg	437 0003	3	339680740051 6

RAILS ROND A VISSER

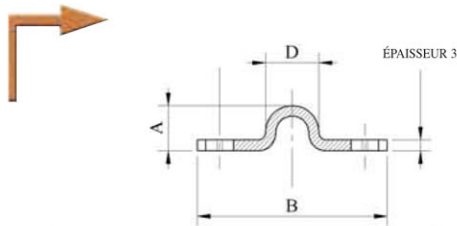

Pièce de Jonction

Ø	CODE	Nbr	EA	EA N 13
Ø16	437 0017	1	339680740124	7
Ø20	437 0015	1	339680740125	4

Ø	A	B	D	Longueur	Poids	Poids	CODE	Nbr	EA N 13
Ø16	13	55	Ø15,5	3 m	500 kg	4,65 kg	437 0012	5	339680740117 9
Ø20	16	55	Ø19,5	3 m	1000 kg	4,80 kg	437 0013	5	339680740052 3

RAIL TRIANGULAIRE A VISSER

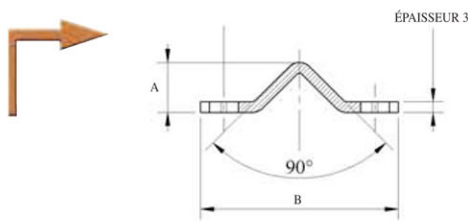

Pièce de Jonction

CODE	Nbr	EA	EA N 13
437 0017	1	339680740124	7

Triangulaire	A	B	Poids	Poids	Longueur	CODE	Nbr	EA N 13
90°	14	55	1000 kg	4,3 kg	3 m	437 0014	5	339680740119 3

CREMAILLERE LARGE

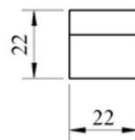
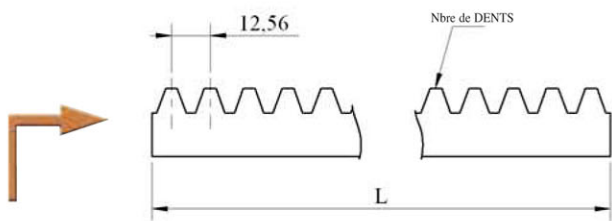

En acier

Longueur	Nbre Dents	X	L	Poids	CODE	Nbr	EA N 13
1 m	80	M.4	1005	3 kg	4370020	10	339680740165 0
2 m	160	M.4	2010	5,97 kg	437 0019	10	339680740136 0

CREMAILLERE STANDARD

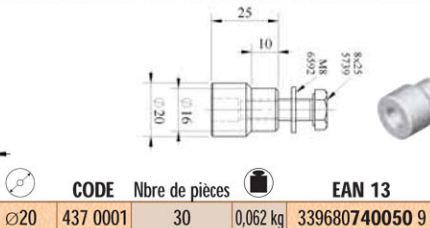
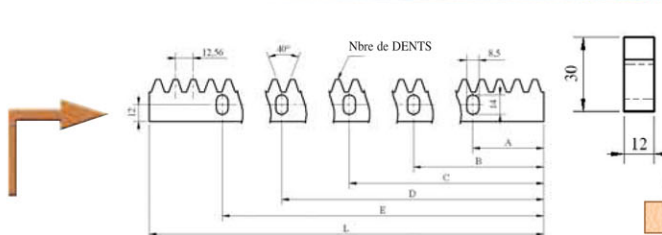

En acier

Longueur	Nbre Dents	X	L	A	B	C	D	E	X	Poids	CODE	Nbr	EA N 13
1 m	80	M. 4	1005	51,5	-	502,4	-	953,5	5	2,38 kg	437 0000	10	339680740049 3
2 m	160	M. 4	2010	50,5	500	1053	1508,5	1957,5	5	4,76 kg	437 0018	10	339680740137 7

Ø	CODE	Nbre de pièces	Poids	EA N 13
Ø20	437 0001	30	0,062 kg	339680740050 9

LA GAMME INOX

PIVOT BAS STANDARD

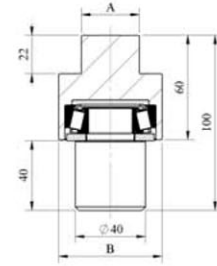

	A	B			CODE		EAN 13
33/45	Ø33	Ø59	500 kg	1,25 kg	446 5007	4	339680740175 9

GOND REGLABLE A SOUDER

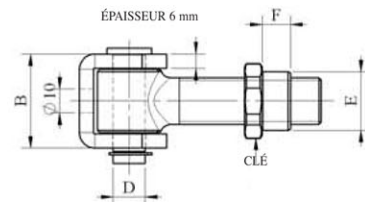
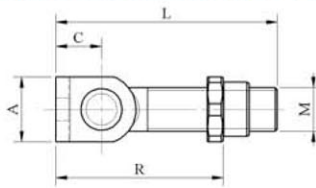

M	B	C	F	L	Clé			CODE		EAN 13
M20	40	21	12	102,5	30	300 kg	0,45 kg	446 5027	10	339680740176 9

RE. GORGE TRIANG.

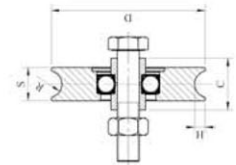

	Rail	C	D	H	S	R					CODE		EAN 13
D 100-1R	Ø20	24	Ø58	5	17	5,3	1	M14x70	100 kg	0,302 kg	432 1071	12	339680740177 6
D 120-1R	Ø20	34	Ø77,5	6,8	20	8,3	1	M14x70	300 kg	0,647 kg	432 1271	6	339680740178 3

RE. GORGE RONDE

	Rail	C	D	H	S	R					CODE		EAN 13
D 100-1R	Ø16	34	Ø97,5	6,8	21	8,3	1	M14x70	280 kg	1,005 kg	433 1071	6	339680740179 0
D 120-1R	Ø20	44	Ø97,5	10,3	28	10,3	2	M14x70	750 kg	1,416 kg	433 1271	6	339680740180 7

SUPPORT INTERIEUR GORGE TRIANGULAIRE

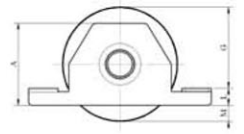
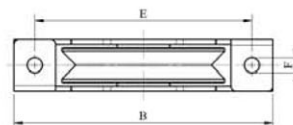
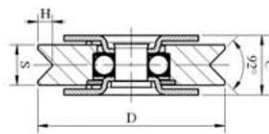

	Rail	A	B	C	D	E	F	G	H	L	M	S				CODE		EAN 13
Ø100	Triangulaire	70	155	44	Ø97,5	130	Ø9	69	10,3	14,5	14	28	2	350 kg	1,550 kg	436 1070	6	339680740183 4
Ø120	Triangulaire	80	185	34	Ø117,5	155	Ø9	85,5	9,3	15	17	24	1	250 kg	2,250 kg	436 1270	6	339680740184 1

RE. GORGE RONDE SUR SUP. INT.

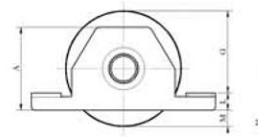
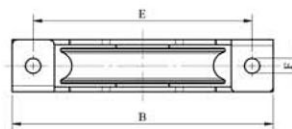
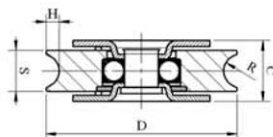

	Rail	A	B	C	D	E	F	G	H	L	M	S	R				CODE		EAN 13
Ø100	Ø16	52	135	32	Ø77,5	110	Ø9	49,5	6,8	14	14	20	8,3	1	200 kg	0,760 kg	436 1071	4	339680740181 0
Ø120	Ø16	70	155	32	Ø97,5	130	Ø9	69	6,8	14,5	14	21	8,3	1	230 kg	1,140 kg	436 1271	6	339680740182 7

LA GAMME INOX

GUIDE OLIVE

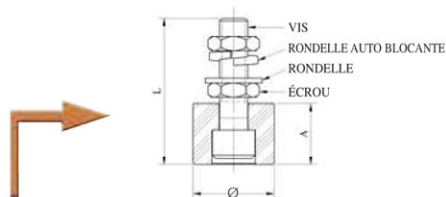

	A	dxL	L		CODE		EAN 13
	30	M14x60	77	0,16 kg	442 0037	8	339680740172 8
	40	M14x60	77	0,19 kg	442 0047	8	339680740173 5

PIVOT HAUT FORTE CHARGE

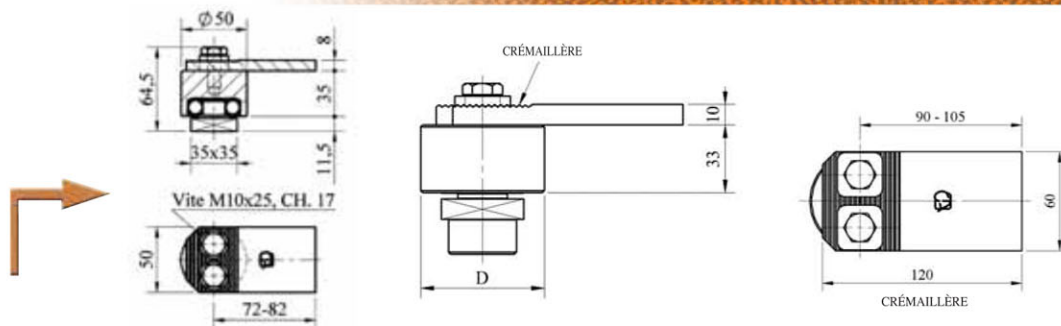

	B	H			CODE		EAN 13	
	50	35x35	54,5	500 kg	1,75 kg	446 4057	4	339680740174 2

GOND AMOVIBLE

A SOUDER

	A	B	C	E	M	R	CODE		EAN 13	
	35	70	84,5	35	41	22	63-95	446 4535	4	339680740203 9
	40	80	92	40	41	22	63-99	446 4540	4	339680740204 6

PLATINE

	A	B	C	E	M	PLATINE	I	R	CODE		EAN 13	
	35	70	84,5	35	41	22	120 x 120	90 x 90	70-100	446 4835	4	339680740205 3
	40	80	92	40	41	22	120 x 120	90 x 90	74-104	446 4840	4	339680740206 0

LE KIT PIVOT HAUT ET BAS



PIVOT HAUT ET BAS POUR PORTAIL

	A	B	dxL	L		CODE		EAN 13
D 30	30	35	M10x30	65	0,12 kg	447 0030	12	339680740199 5
D 40	40	42	M10x30	77	0,19 kg	447 0040	8	339680740200 8
D 50	50	52,5	M16x40	102,5	0,39 kg	447 0050	10	339680740201 5
D 60	60	62,5	M16x40	102,5	0,39 kg	447 0060	10	339680740202 2

GUIDES OLIVE - PLAQUES GUIDES

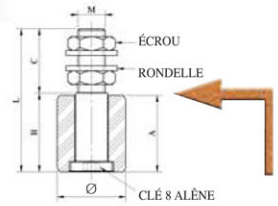

GUIDE NYLON STANDARD

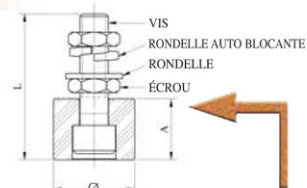
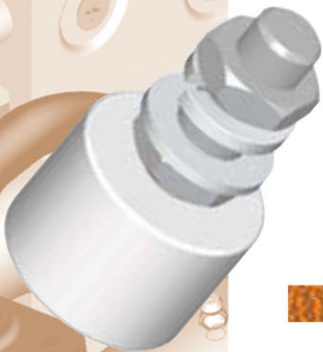

Ø	A	B	 d x L	L		CODE		EAN 13
25	33	35	M14x30	65	0,12 kg	442 0025	12	339680740055 4
30	40	42	M14x35	77	0,19 kg	442 0030	8	339680740056 1
40	60	62,5	M16x40	102,5	0,39 kg	442 0040	10	339680740057 8

GUIDE NYLON CYLINDRIQUE



Ø	A	 d x L	L		CODE		EAN 13
30	30	M14x60	77	0,16 kg	450 0030	8	339680740088 2
40	30	M14x60	77	0,19 kg	450 0040	8	339680740089 9

GUIDE LAITON

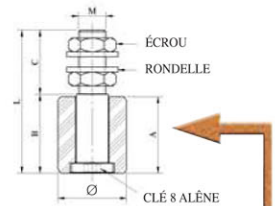

Ø	A	B	 d x L	L		CODE		EAN 13
40	60	62,5	M16x40	102,5	0,17 kg	442 1042	10	339680740058 5

GUIDE NYLON BOMBE

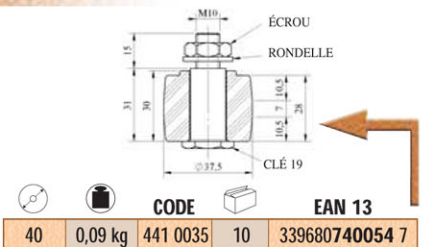



Ø		CODE		EAN 13
40	0,09 kg	441 0035	10	339680740054 7

PLAQUE GUIDES (2 GUIDES NYLON BOMBES)

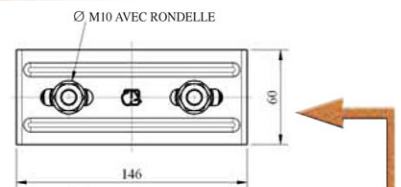
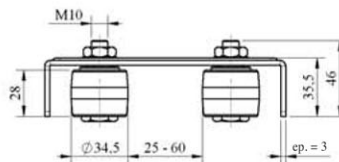
Ensemble de guidage haut de portail





	CODE		EAN 13
0,45 kg	440 0001	10	339680740142 1

PLAQUE GUIDES (4 GUIDES NYLON STANDARDS)

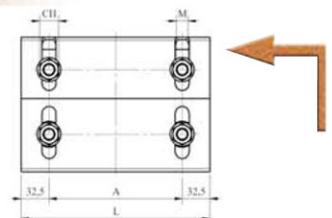
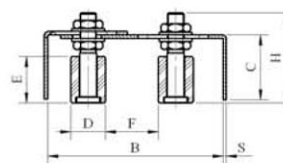
Ensemble de guidage réglable haut de portail



A	B	C	D	E	F	H	L	M	CH	S		CODE		EAN 13
155	139-173	56	Ø30	40	17-71	77	220	M14	22	3	1,27 kg	440 0000	6	339680740053 0

SERRURES - POIGNÉES

SERRURE

Serrure équipée avec cran et 3 clefs - Finition bichromatée

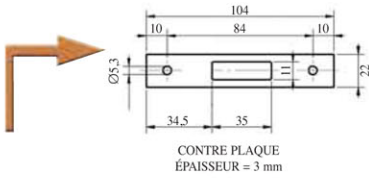

CONTRE PLAQUE
ÉPAISSEUR = 3 mm

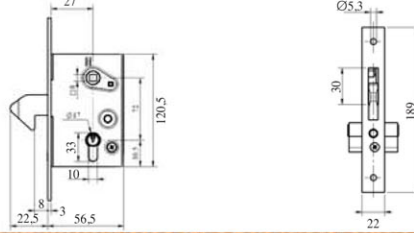

CODE	EAN 13
1,350 kg 445 0002 1	339680740129 2

SERRURE

Serrure équipée avec cran et 3 clefs - Finition bichromatée

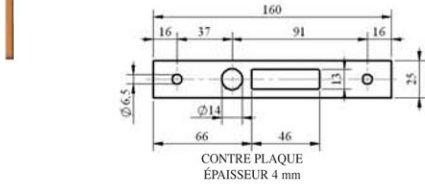

CONTRE PLAQUE
ÉPAISSEUR 4 mm

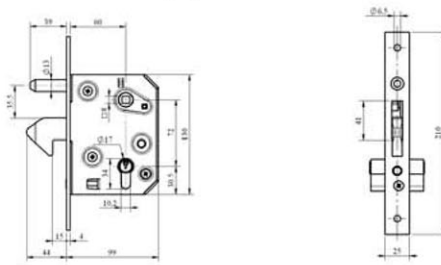

CODE	EAN 13
1,350 kg 445 0000 1	339680740164 3

BOITIER

Boîtier de protection de serrure pour tube carré de 40 ou 50 mm
Finition brut

A	CODE	EAN 13
40 20 0,60 kg 445 0040 6	339680740063 9	
50 10 0,58 kg 445 0050 6	339680740064 6	

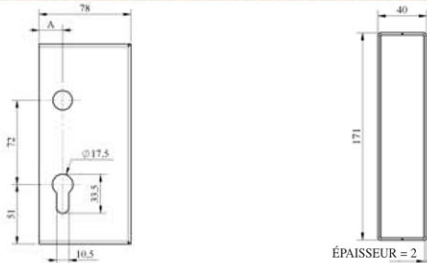

POIGNÉE

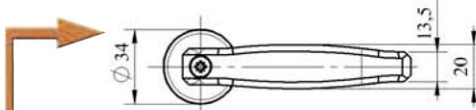

L	CODE	EAN 13
40-50 0,250 kg 445 0020 20	339680740061 5	
50-60 0,260 kg 445 0030 20	339680740062 2	

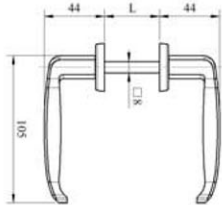

POIGNÉE CUVETTE

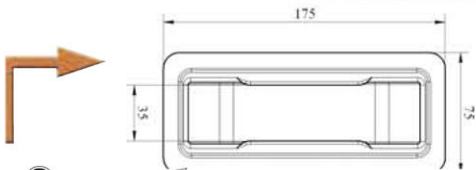

CODE	EAN 13
0,21 kg 445 2090 30	339680740066 0

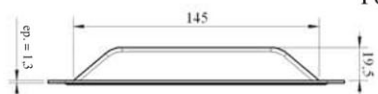

Poignée cuvette zinguée à encastrer

POIGNÉE DE TIRAGE

Finition epoxy noire

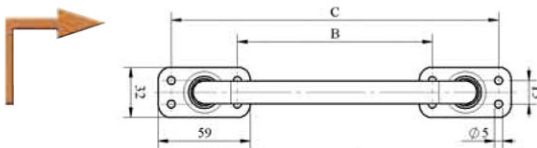

A	B	C	CODE	EAN 13
180	125	210	0,430 kg 445 1020 10	339680740065 3

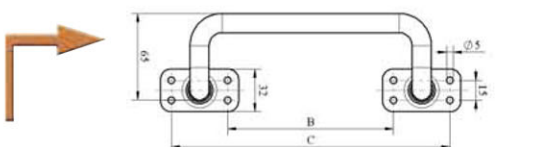
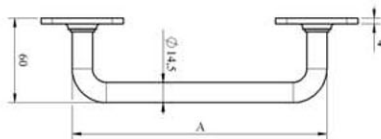

A	B	C	CODE	EAN 13
180	125	210	0,580 kg 445 1120 10	339680740140 7
230	175	260	0,640 kg 445 1121 10	339680740141 4



BUTÉES

BUTÉE DE PORTAIL A SOUDER

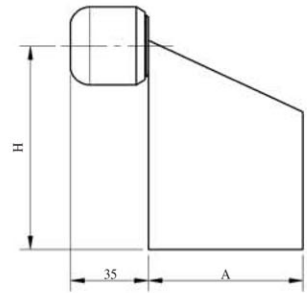
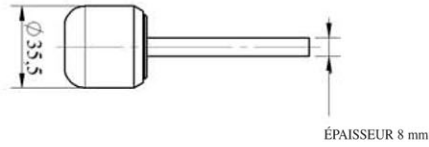
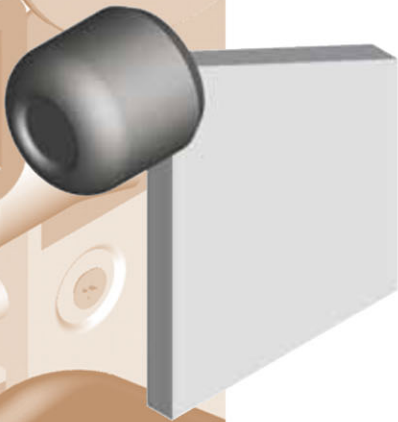

Butée à souder en bout de rail

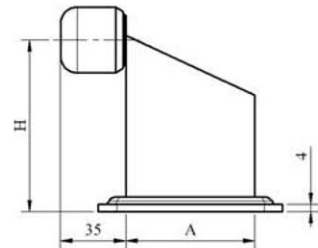
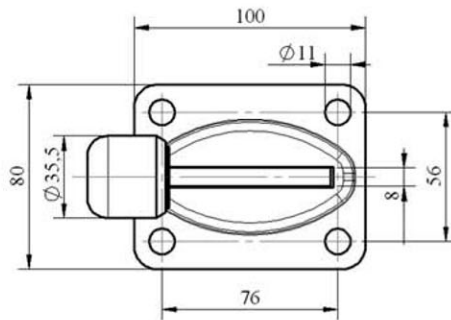
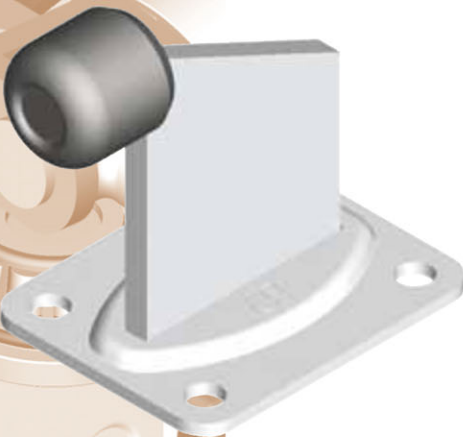

A	H	 kg	CODE		EAN 13
70	92,5	0,57	443 0000	10	339680740059 2

BUTÉE DE PORTAIL A PLATINE



A	H	 kg	CODE		EAN 13
70	93,5	0,90	443 0010	10	339680740143 8

BUTÉE DE PORTAIL SUR RAIL RONDE

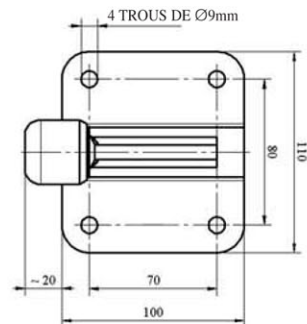
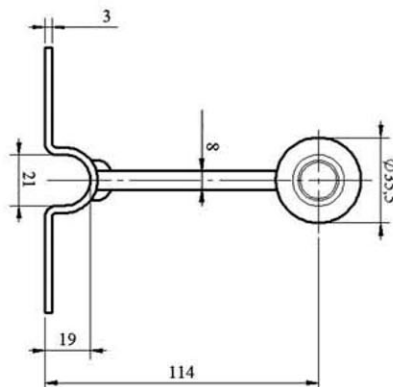
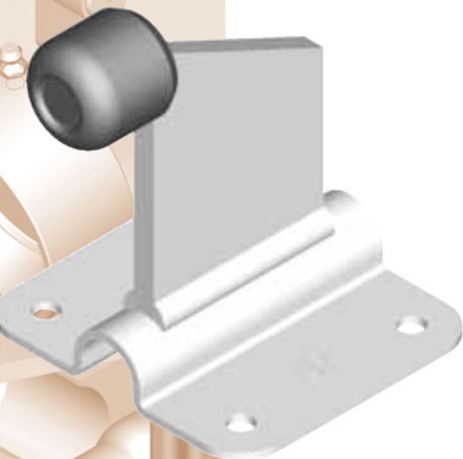

 kg	CODE		EAN 13
1,05	443 0020	10	339680740144 5

BUTÉES

BUTÉE A SCELLER

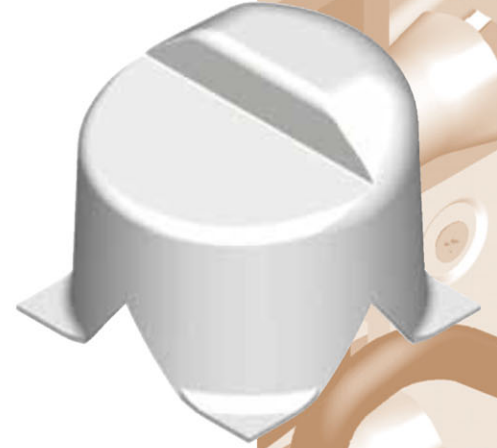
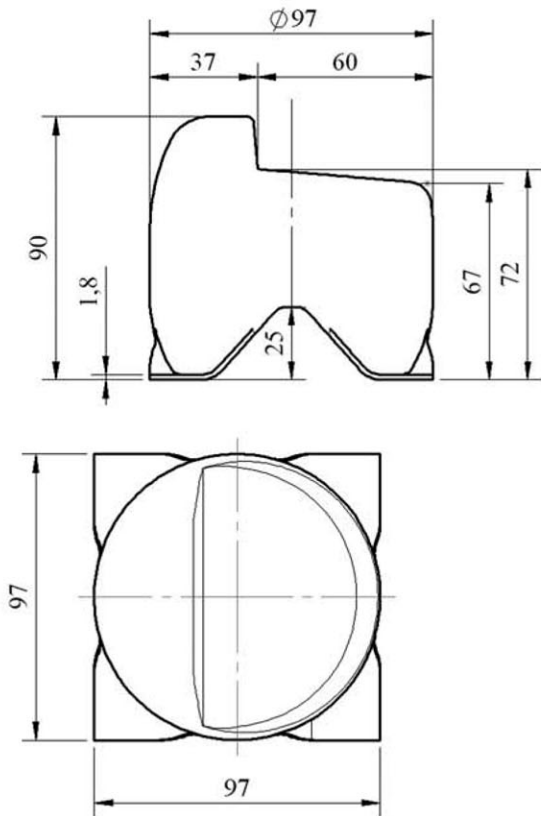

Weight	CODE	Box	EAN 13
0,348 kg	444 0000	16	339680740113 1

BUTÉE A VISSER

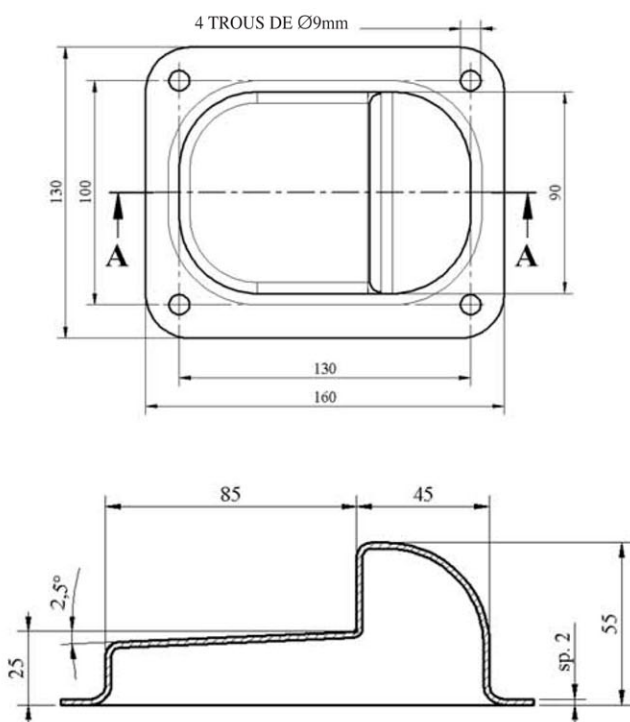

Weight	CODE	Box	EAN 13
0,25 kg	444 0001	16	339680740145 2

PIVOTS À SOUDER POUR TUBES

PIVOT HAUT STANDARD

Pour tube rond ou carré - Finition zinguée

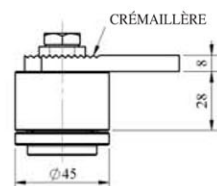
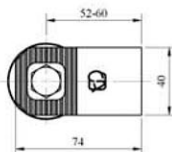
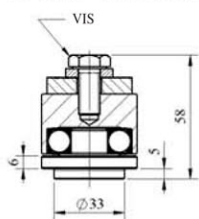

Ø	Weight	Weight	CODE	Box	EAN 13
45	300 kg	0,40 kg	446 4000	4	339680740073 8

PIVOT BAS STANDARD ET FORTE CHARGE

Pour tube rond ou carré - Finition zinguée

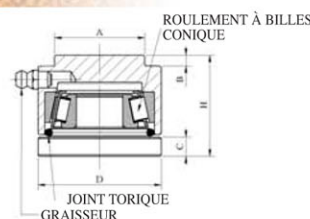

Ø	A	B	C	D	H	Weight	Weight	CODE	Box	EAN 13
45	Ø33	4	7	Ø45	37	500 kg	0,33 kg	446 5000	4	339680740 076 9
68	-	-	8	Ø68	40	700 kg	0,61 kg	446 5068	4	339680740147 6

PIVOT HAUT FORTE CHARGE

Pour tube rond ou carré - Finition zinguée

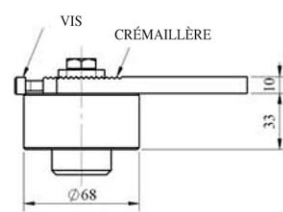
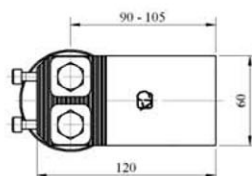
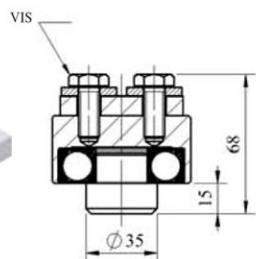
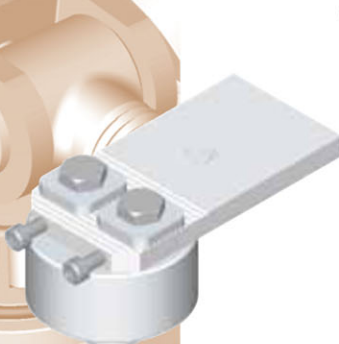

Ø	Weight	Weight	CODE	Box	EAN 13
68	500 kg	1,68 kg	446 4035	4	339680740146 9

PIVOT HAUT POUR TUBE ROND OU CARRÉ

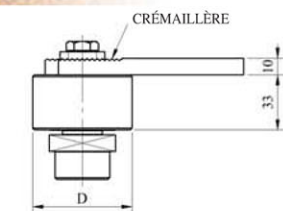
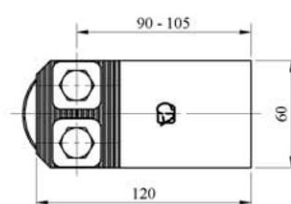
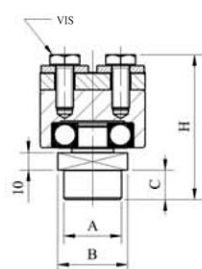

Tube	Ø	A	B	C	D	H	Weight	Weight	CODE	Box	EAN 13
Tube 40	Ø33	40x40	17	Ø60	84	500 kg	1,75 kg	446 4040	4	339680740074 5	
Tube 50	Ø43	50x50	17	Ø60	84	700 kg	1,90 kg	446 4050	4	339680740075 2	

PIVOT HAUT POUR TUBE ROND OU CARRÉ

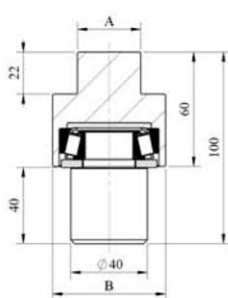

Tube	Ø	A	B	Weight	Weight	CODE	Box	EAN 13
Tube 40	Ø33	Ø59	500 kg	1,25 kg	446 5040	4	339680740077 6	
Tube 50	Ø43	Ø59	700 kg	1,40 kg	446 5050	4	339680740078 3	

PIVOTS - PAUMELLE A SOUDER

PIVOT ALLEMAND

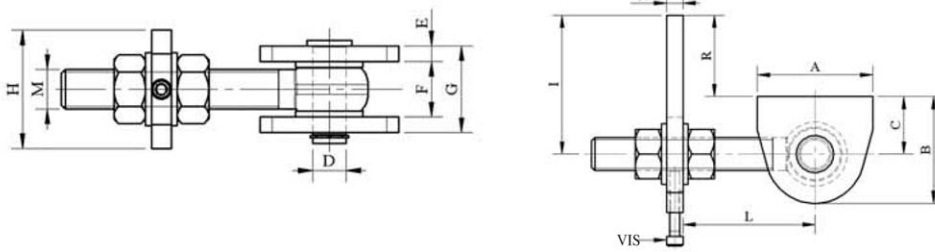

	A	B	C	D	E	F	G	H	I	L	M	N	R			CODE	EAN 13
16	45	48	27	∅14	6	23	35	50x98	54-70	40-94	M16	8	27-43	200 kg	0,96 kg	446 5098	339680740148 3
20	70	65	35	∅17	8	28	44	60x120	72-97	55-105	M20	10	37-62	300 kg	1,57 kg	446 6012	339680740149 0
24	70	65	35	∅20	8	34	50	70x135	88-110	59-116	M24	12	53-75	400 kg	2,22 kg	446 7013	339680740207 7

PAUMELLE A SOUDER

En acier à souder sans plomb.
Pivot en acier bichromaté
avec bague à billes

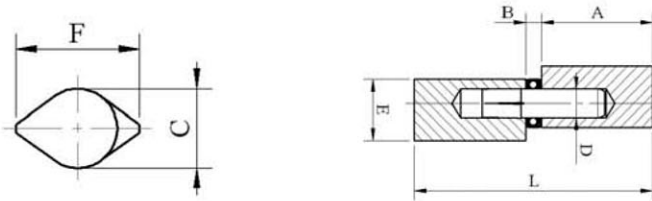

Type	A	B	E	C	F	L	D			CODE	EAN 13
140	67	6,5	24	∅20	28	142	∅12	300 kg	0,22 kg	491 0140	339680740127 8
160	77	6,5	24	∅20	28	162	∅12	400 kg	0,24 kg	491 0160	339680740128 5

PIVOT SPHERIQUE

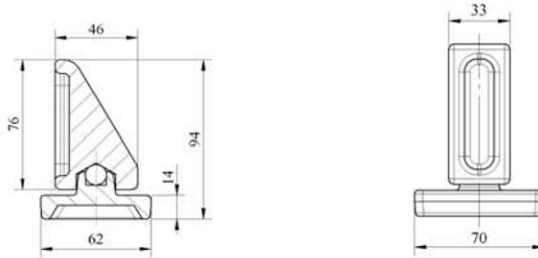

		CODE		EAN 13
300 kg	0,750 kg	446 0000	6	339680740067 7

PIVOT BAS



D	A	B	C	E	F	H			CODE		EAN 13
∅24	24	56	33	35	11	97	300 kg	0,310 kg	447 0024	6	339680740079 0

PLAQUE DE BASE

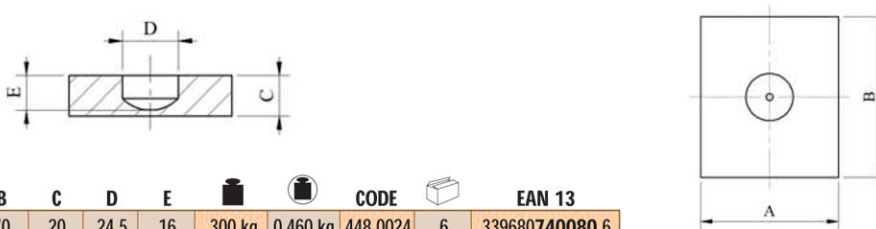

		CODE		EAN 13
300 kg	0,460 kg	448 0024	6	339680740080 6

GONDS RÉGLABLES

A SCCELLER

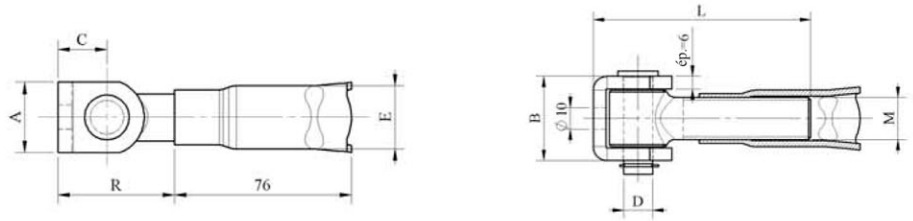
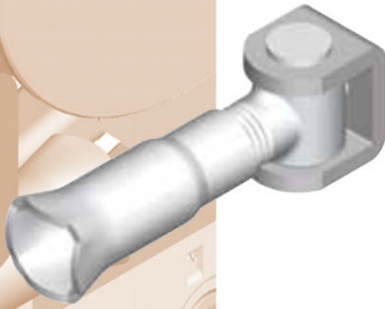

M	A	B	E	L			CODE		EAN 13
M20	30	40	∅27	102,5	300 kg	0,48 kg	446 0020	10	339680740068 4
M24	35	46	∅32	97	450 kg	0,61 kg	446 0024	6	339680740150 6

A TIGE FILETEE

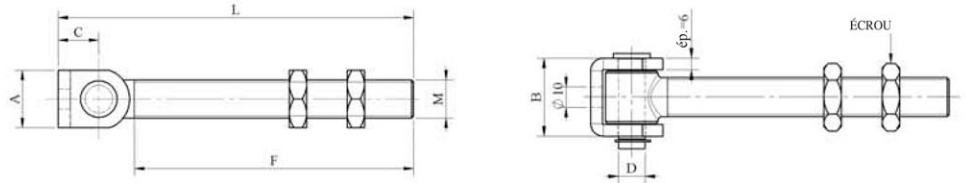
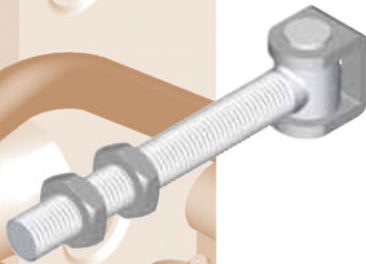

M	A	B	C	D	F	L	Clé			CODE		EAN 13
M20	30	40	21	∅14	145	184,5	30	300 kg	0,650 kg	446 0120	10	339680740070 7
M24	35	46	25,5	∅17	140	191	30	450 kg	0,950 kg	446 0124	6	339680740163 6

A SOUDER SUR RONDELLE

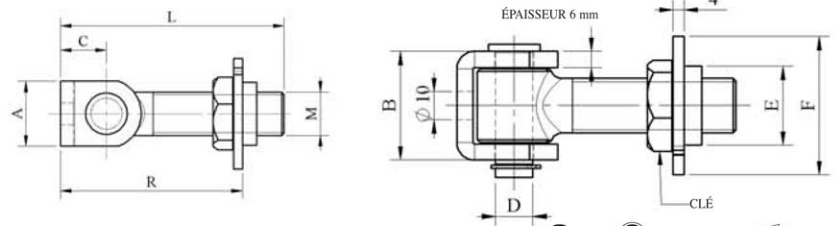
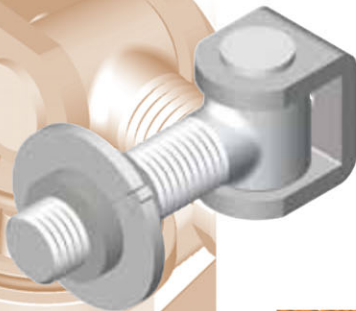

M	A	B	C	D	E	F	L	R	Clé			CODE		EAN 13
M20	30	40	21	∅14	∅29	∅51	102,5	56-96	30	300 kg	0,450 kg	446 2020	10	339680740071 4
M24	35	46	25,5	∅17	∅35	∅56	97	66-88	36	450 kg	0,750 kg	446 2124	6	339680740151 3

A SOUDER

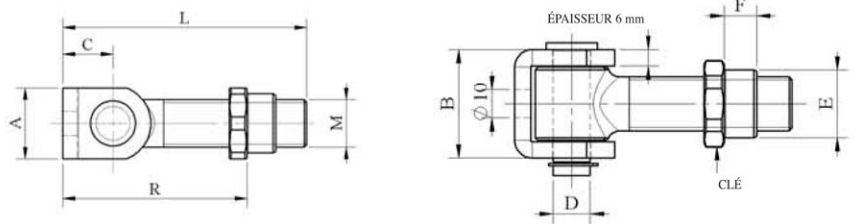
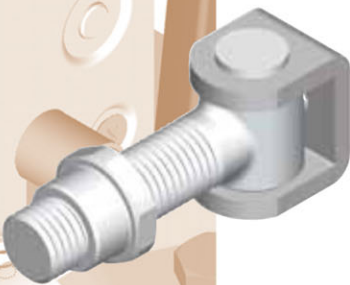

M	B	C	F	L	Clé			CODE		EAN 13
M20	40	21	12	102,5	30	300 kg	0,45 kg	446 5020	10	339680740152 0
M24	46	25,5	15	97	36	450 kg	0,72 kg	446 5046	6	339680740153 7

A PLATINE

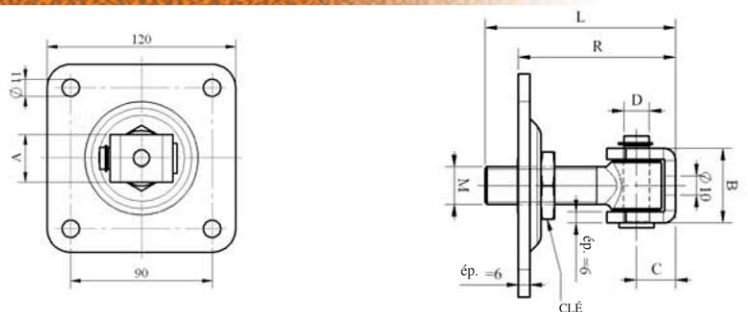
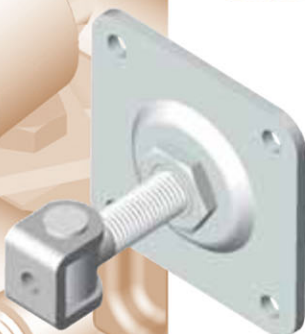

M	A	B	C	D	L	R	Clé			CODE		EAN 13
M20	30	40	21	∅14	102,5	62-102	30	300 kg	0,82 kg	446 3020	10	339680740072 1

GONDS RÉGLABLES

STANDARD

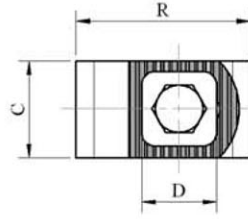
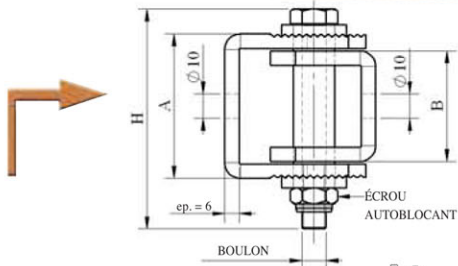

A	B	C	D	H	R				CODE		EAN 13
60	46	35	27x27	91	58-71	M10x65	300 kg	0,560 kg	446 0065	10	339680740069 1

A SCELLER

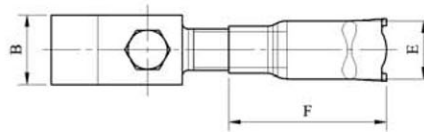
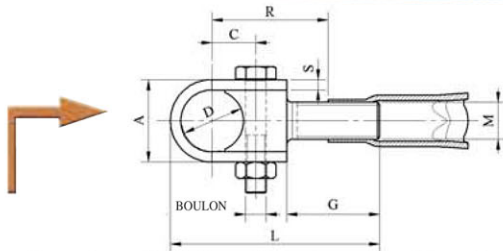

D	A	B	C	E	F	G	M	L	R	S				CODE		EAN 13
Ø35	47	35	26,5	Ø30	76	45	M22	112,5	48,5-71,5	6	M12x60	300 kg	0,820 kg	446 1035	12	339680740154 4

A SOUDER SUR RONDELLE

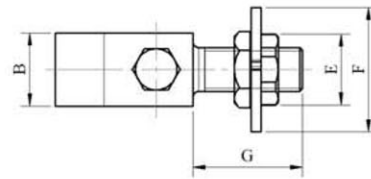
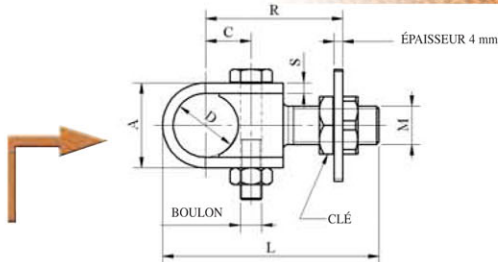

D	M	A	B	C	E	F	G	L	R	S		Clé			CODE		EAN 13
Ø35	M22	47	35	26,5	Ø35	Ø56	45	112,5	63-81	6	M12x60	32	300 kg	0,700 kg	446 7035	6	339680740155 1
Ø40	M27	52	40	30,5	Ø40	Ø59	55	129,5	79,5-95,5	6	M12x70	41	450 kg	0,980 kg	446 7040	6	339680740156 8

A PLATINE

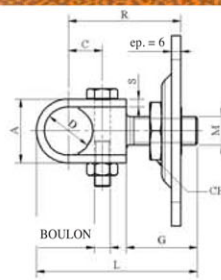
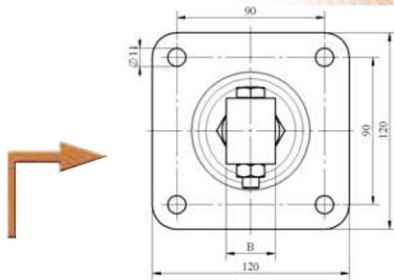

D	A	B	C	G		Clé			CODE		EAN 13	
35	35	35	35	M22	45	M12x60	36	300 kg	1,300 kg	446 3022	12	339680740157 5

COUSSINET

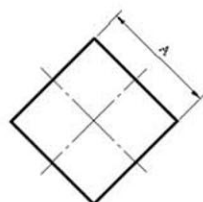
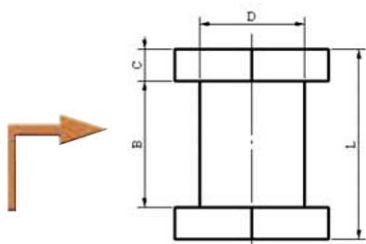

D	A	B	C	E	F			CODE		EAN 13
Ø35	37	57	66	Ø29	35x35	300 kg	0,53 kg	446 1135	12	339680740158 2
Ø40	45	63	73	Ø34	40x40	450 kg	0,73 kg	446 1140	12	339680740159 9

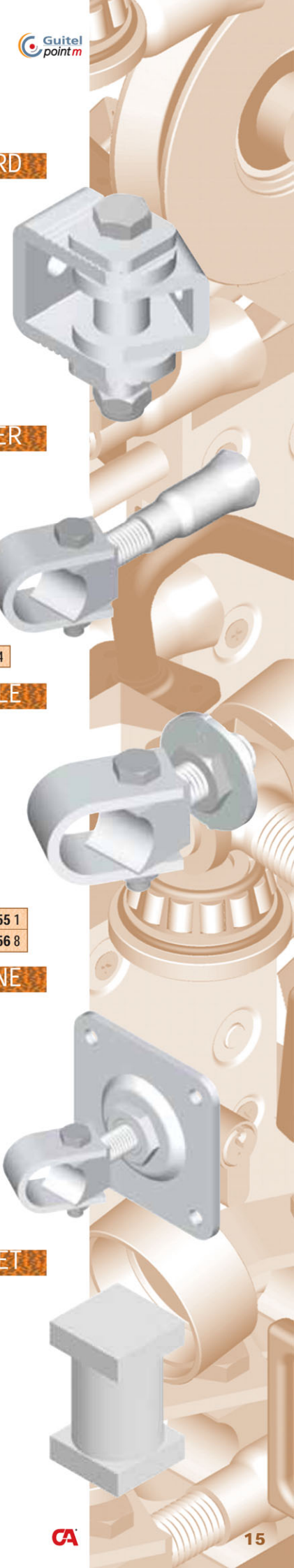

CREMONES ET VERROUS

CREMONE A LEVIER "NOIRE"

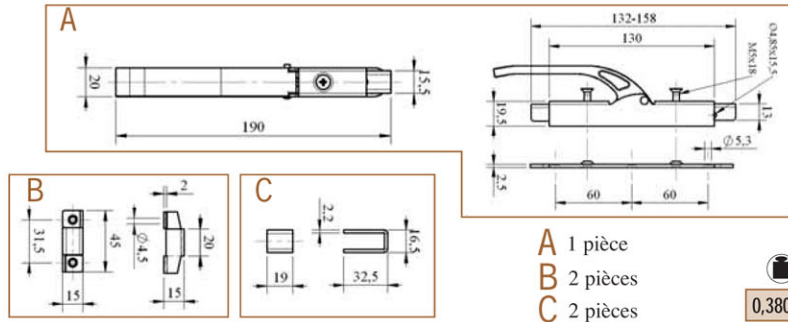

- A 1 pièce
- B 2 pièces
- C 2 pièces

0,380 kg	CODE 453 0016	2	EAN 13 339680740120 9
----------	---------------	---	-----------------------

Crémones à levier pour carré de 10 mm avec les accessoires (carré non fourni)

CREMONE A LEVIER ZINGUEE

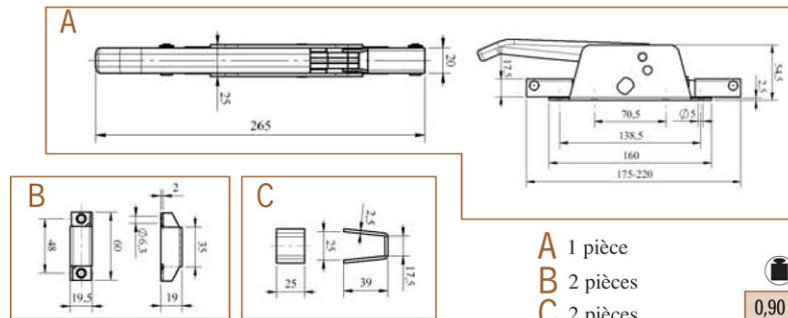

- A 1 pièce
- B 2 pièces
- C 2 pièces

0,90 kg	CODE 453 0000	5	EAN 13 339680740093 6
---------	---------------	---	-----------------------

Crémones à levier pour carré de 14 mm avec les accessoires (carré non fourni)

CREMONE A LEVIER ZINGUEE A CLEFS

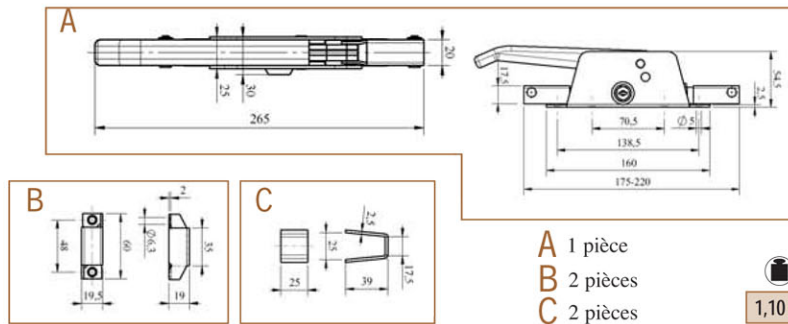
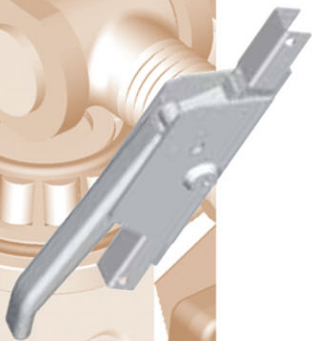

- A 1 pièce
- B 2 pièces
- C 2 pièces

1,10 kg	CODE 453 0005	5	EAN 13 339680740094 3
---------	---------------	---	-----------------------

Crémones à levier pour carré de 14 mm (fourni avec clés) (carré non fourni)

VERROU CARRE

Équipé de 2 guides

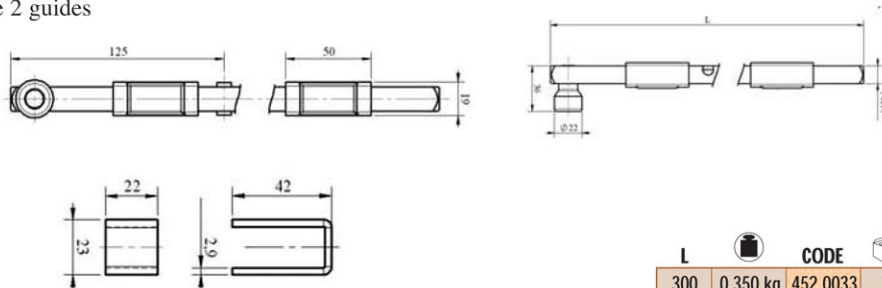
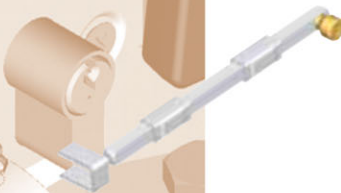

L 300	0,350 kg	CODE 452 0033	10	EAN 13 339680740091 2
-------	----------	---------------	----	-----------------------

VERROU PORTE CADENAS

Finition zinguée

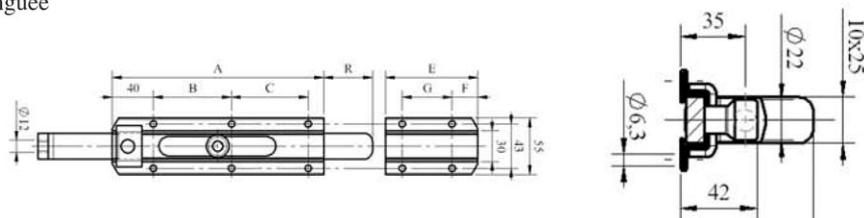
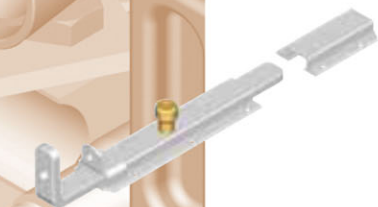

Longueur 200 mm	A 140	B 84	C -	E 50	F 17	G 18,5	R 0-58	0,840 kg	CODE 452 1020	5	EAN 13 339680740092 9
-----------------	-------	------	-----	------	------	--------	--------	----------	---------------	---	-----------------------

COUVRE POTEAUX

COUVRE POTEAUX SCULPTE



☑	A	H	SP	CODE	☑	EAN 13
70	∅72	97	1,5	449 0072	10	339680740224 4
100	∅102	148	2	449 0102	8	339680740225 1

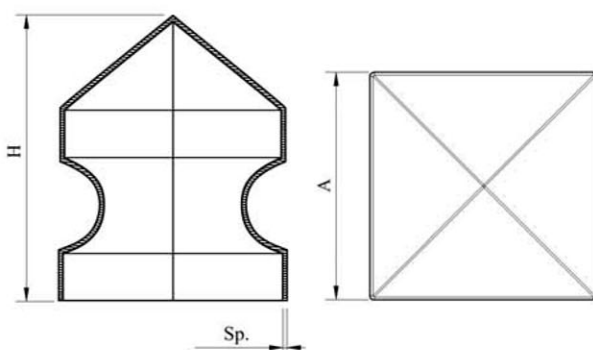

COUVRE POTEAUX CARRE

Finition brut

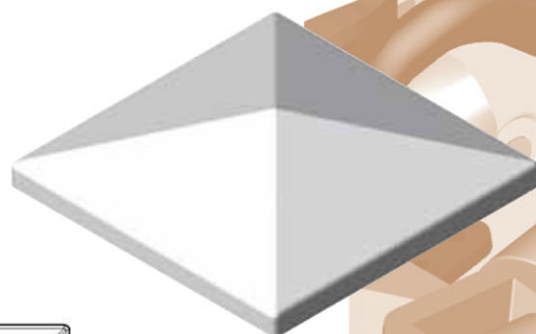
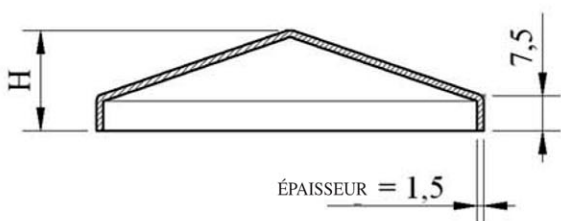

☑	A	H	📦	CODE	☑	EAN 13
40	44	15	0,038 kg	449 0040	100	339680740081 3
50	54	17	0,052 kg	449 0050	100	339680740082 0
60	64	20	0,067 kg	449 0060	70	339680740083 7
80	84	22	0,109 kg	449 0080	50	339680740084 4
100	104	26	0,163 kg	449 0100	40	339680740085 1
120	124	29	0,222 kg	449 0120	36	339680740086 8
150	154	35	0,343 kg	449 0150	32	339680740087 5

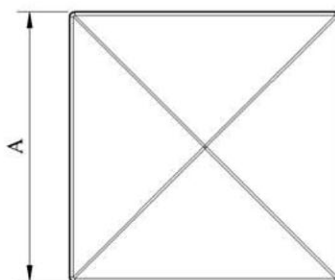

COUVRE POTEAUX ROND

Finition brut

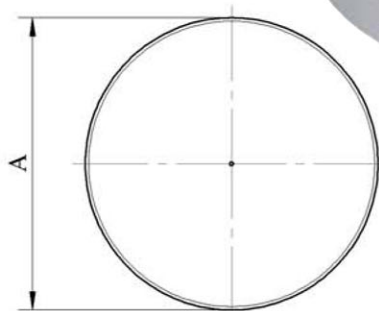
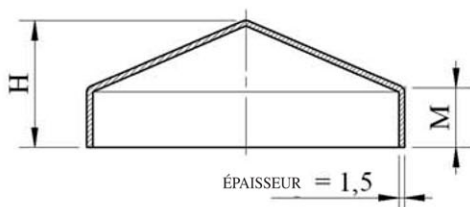

☑	A	H	M	📦	CODE	☑	EAN 13
76	∅80	32	15	0,096 kg	448 0076	50	339680740161 2
101	∅105	32	13	0,148 kg	448 0101	36	339680740162 9

L'AUTO PORTANT

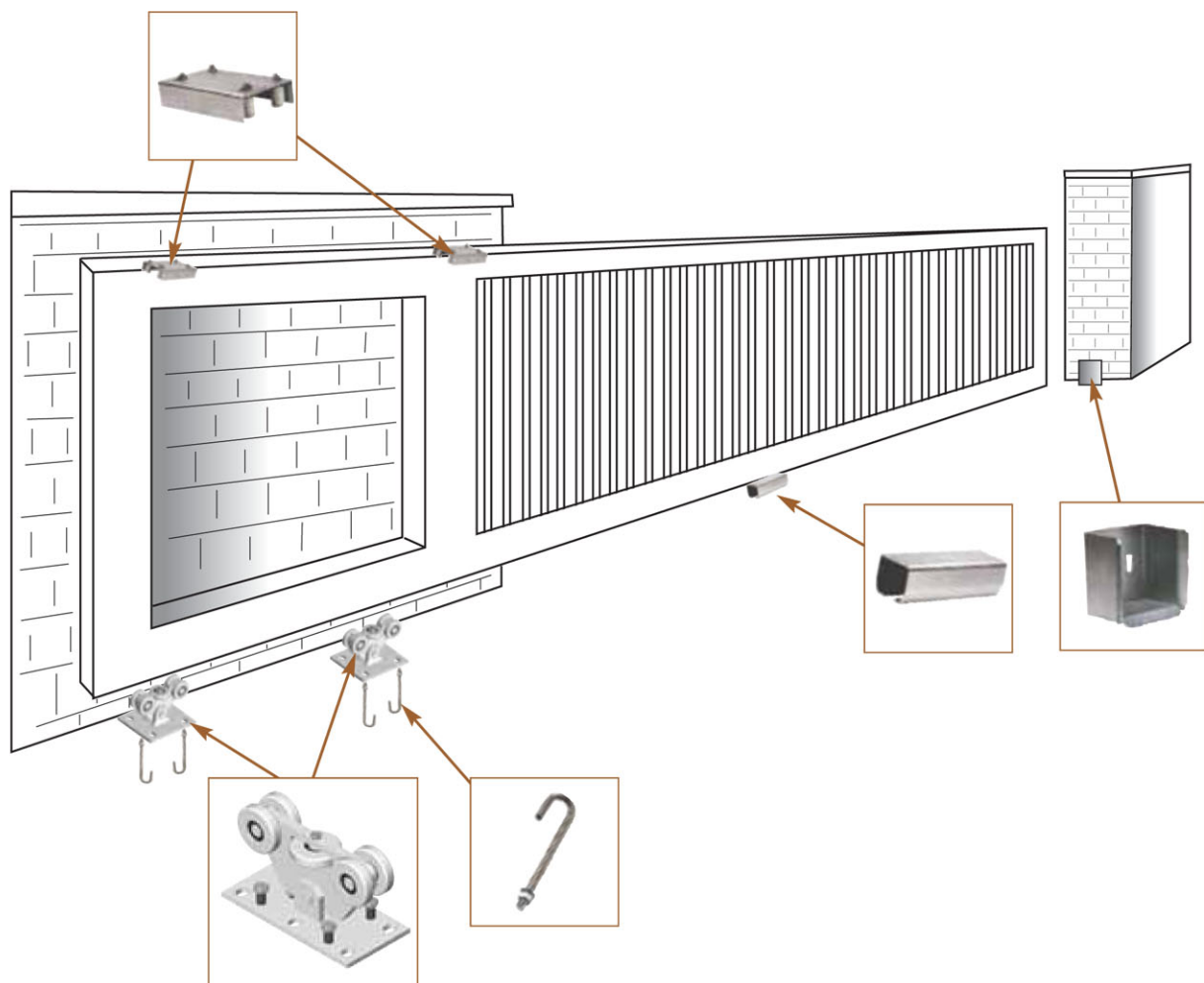

Nous consulter pour un devis
de portail autoportant



Chariot de guidage
pour portail
autoportant

Le portail autoportant
fonctionne sans rail au sol.
Il permet une installation
sur un sol irrégulier ou
en pente.
Préconisé également en cas
de passage de véhicules lourds
ou de circulation intensive.
Possibilités de réalisation
du portail autoportant :
3 à 10 mètres
(poids variant entre 300
et 2000 Kg).

L'AUTO PORTANT

CHARIOT AUTOPORTANT

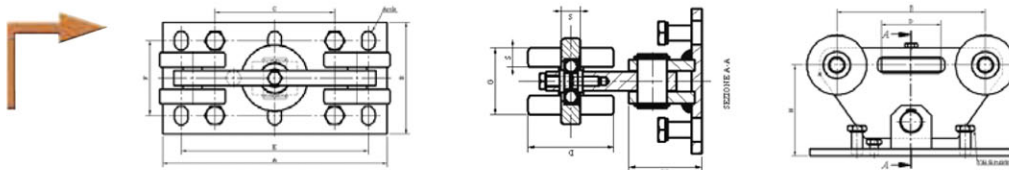

Dim	A	B	C	D	E	F	G	H	I	M	S	vis	CODE	EAN 13	
Petit	180	150	-	ø 59	125	100	52	100	135	60	15	n4 - 18x25	5,6 kg	438 0059	1 339680740185 8
Moyen	300	150	160	ø 88	250	100	69	135	220	75	20	n6 - 18x25	13,65 kg	438 0088	1 339680740186 5
Grand	500	200	320	ø 126	440	150	99	187	380	105	30	n6 - 22x30	41 kg	438 0126	1 339680740187 2

BUTEE D'ARRET AUTOPORTANT

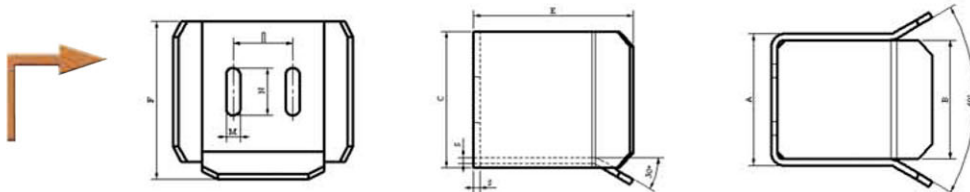

Dim	A	B	C	E	F	I	M	N	S	CODE	EAN 13	
Petit	86	78	90	105	105	38	9	30	4	0,975 kg	444 0078	2 339680740188 9
Moyen	121	113	120	119	134	50	11	30	4	1,894 kg	444 0113	2 339680740189 6
Grand	164	154	165	140	179	75	13	35	5	3,6 kg	444 0154	2 339680740190 2

EMBOUIT POUTRE A GALET

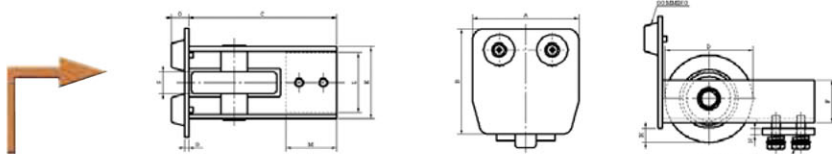

Dim	A	B	C	D	E	F	G	H	L	M	N	O	S	vis	CODE	EAN 13	
Petit	67	67	120	ø 68	45	32	4	14,5	45	46	4	16	15	n2 - M8x25	0,98 kg	444 0067	2 339680740191 6
Moyen	100	100	135	ø 78	66	38	4	12,5	55	46	6	16	20	n2 - M8x25	1,675 kg	444 0100	2 339680740192 3
Grand	140	140	165	ø 98	95	55	5	14	90	60	6	17	30	n2 - M10x25	3,95 kg	444 0140	2 339680740193 0

RAIL AUTOPORTANT

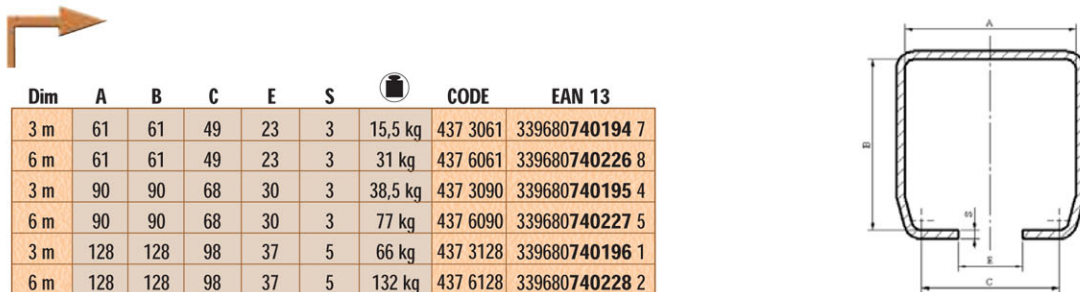

Dim	A	B	C	E	S	CODE	EAN 13
3 m	61	61	49	23	3	15,5 kg	437 3061 339680740194 7
6 m	61	61	49	23	3	31 kg	437 6061 339680740226 8
3 m	90	90	68	30	3	38,5 kg	437 3090 339680740195 4
6 m	90	90	68	30	3	77 kg	437 6090 339680740227 5
3 m	128	128	98	37	5	66 kg	437 3128 339680740196 1
6 m	128	128	98	37	5	132 kg	437 6128 339680740228 2

CROCHET D'ANCRAGE FILETE

6 par chariot

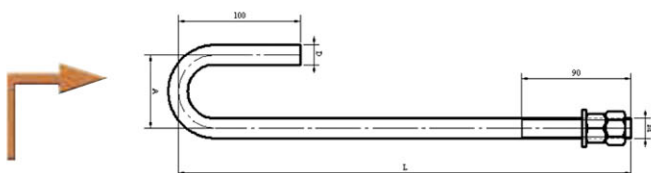

	A	D	L	M	CODE	EAN 13
M 16	60	ø 16	370	M 16	3 kg	451 0016 10 339680740197 1
M 20	80	ø 20	375	M 20	5,97 kg	451 0020 10 339680740198 8

LANCES

LANCES DECORATIVES EN ACIER A SOUDER

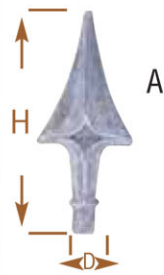

	D	H		CODE		EAN 13
A	16	160	0,320 kg	454 0000	50	339680740096 7

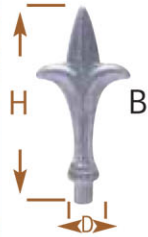

	D	H		CODE		EAN 13
B	12	125	0,140 kg	454 1012	50	339680740097 4
	16	160	0,360 kg	454 1016	20	339680740098 1

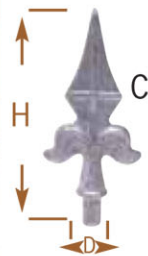

	D	H		CODE		EAN 13
C	12	125	0,180 kg	454 2012	50	339680740099 8
	16	160	0,360 kg	454 2016	50	339680740100 1

MOULURES

MOULURES "MILIEU"



D	H	DI		CODE		EAN 13
40	70	14,5	0,230 kg	455 1114	50	339680740101 8
40	70	16,5	0,310 kg	455 1116	50	339680740102 1

MOULURES BASSE



D	H	DI		CODE		EAN 13
40	39	14,5	0,170 kg	455 2114	50	339680740103 2
40	39	16,5	0,300 kg	455 2116	50	339680740104 9

MOULURES DES LANDES

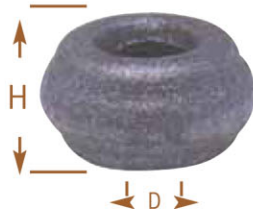

D	H	DI		CODE		EAN 13
40	21,5	16,5	0,070 kg	455 3116	100	339680740105 6



Service commercial

165 rue Jean Jaurès
94700 Maisons-Alfort

Tél : +33 (0)1.45.17.91.00
Fax : +33 (0)1.48.99.09.36
commande@guitel-hervieu.fr
info@guitel-hervieu.fr



Siège social et production

Rue Marcel Poulin
60400 Crisolles

Tél : +33 (0)3.44.93.26.20
Fax : +33 (0)3.44.93.26.28

www.guitel-hervieu.fr

Guitel Hervieu une société du

